

AC INFINITY

CLOUDLIFT

WALL AND FLOOR CIRCULATOR FAN

USER MANUAL

WELCOME

Thank you for choosing AC Infinity. We are committed to product quality and friendly customer service. If you have any questions or suggestions, please don't hesitate to [contact](#) us. Visit www.acinfinity.com and click contact for our contact information.

EMAIL

support@acinfinity.com

WEB

www.acinfinity.com

LOCATION

Los Angeles, CA

MANUAL CODE CL2212X2

PRODUCT

CLOUDLIFT S12
CLOUDLIFT S14
CLOUDLIFT S20
CLOUDLIFT S24

MODEL

AC-WFS12
AC-WFS14
AC-WFS20
AC-WFS24

UPC-A

819137022263
819137022430
819137022485
819137022492

MANUAL INDEX

Manual Index	Page 5
Product Warning	Page 6
Key Features	Page 7
Product Contents	Page 8
Installation	Page 9
Powering and Setup	Page 11
Controller Mounting	Page 13
UIS™ Platform	Page 15
UIS™ Compatibility	Page 16
Adding More Devices	Page 17
Programming	Page 18
Other AC Infinity Products	Page 19
Warranty	Page 20

PRODUCT WARNING



TO REDUCE THE RISK OF FIRE, ELECTRIC SHOCK, OR INJURY TO PERSONS,
OBSERVE THE FOLLOWING:

1. Ensure your power source conforms to the electrical requirements of this product.
2. Check your local code restrictions for additional safety measures that may be needed for a proper code compliant installation.
3. Read all instructions before installing and using this product.
4. If you are unfamiliar or have doubts about performing this product's installation, seek the services of a qualified, trained, and licensed professional. Inappropriate installation will void this product's warranty.
5. Do not attempt to hardwire this product. Performing any retrofitting actions may result in personal injury and/or electrical damage, and will void this product's warranty.
6. This product must not be used in potentially hazardous locations such as flammable, explosive, chemical-laden or wet atmospheres.
7. Do not cover power cords with rugs or other fabric materials.
8. This product has rotating parts. Safety precautions should be exercised during the installation, operation, and maintenance of this product.
9. Do not insert or allow fingers or foreign objects to enter through the fan grille as it may cause electric shock, fire, or damage to this product. Do not block or tamper with this product in any manner while it is in operation.
10. Do not depend on the on/off programming as the sole means of shutting power from this product. Unplug the power cord before installing, servicing, or moving this product.
11. Do not operate this product while its cord is damaged, or if it malfunctions, has been dropped, or is damaged in any manner.

KEY FEATURES

EC MOTOR

Next generation motor runs quieter, is more energy efficient, and has a longer lifespan than AC motors.

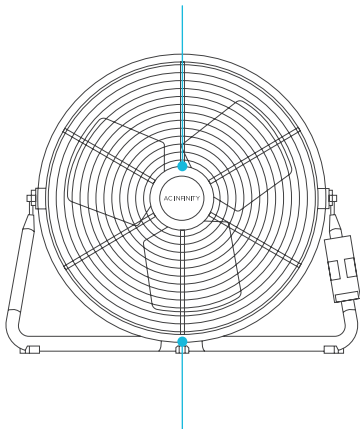

IP44 PROTECTION

This industrial wall fan is sealed to Ingress Protection 44 standards, rated with high resistance to liquids and dust.

RUGGED BUILD

Black powder-coated steel fan guard supported by a rigid floor stand cages the fan blades for long-lasting performance.

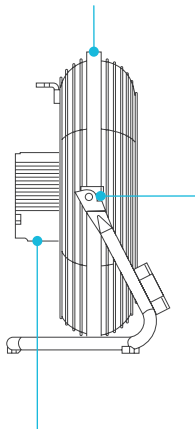

DUAL BALL BEARINGS

The motor contains ball bearings with an estimated 67,000 hour lifespan. Enables the fan to be mounted in any direction.

WIDER COVERAGE

Pivoting fan head on the floor or wall-mounted creates dynamic circulation to direct airflow in a wide range.

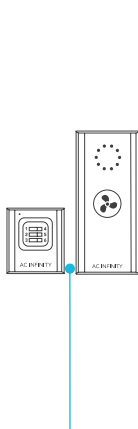

SPEED CONTROLLER

Single button controller with circular dot display wirelessly enables fan speed control in ten speeds.

PRODUCT CONTENTS

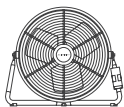

INDUSTRIAL
WALL FAN
(x1)



WIRELESS
CONTROLLER
(x1)



WIRELESS
RECEIVER
(x1)



AAA
BATTERIES
(x2)



UIS™ M-M
CORD, 20 IN.
(x1)



UIS™ M-M
CORD, 10 FT.
(x1)



WALL-HANG
BRACKET
(x1)



WOOD SCREWS
(WALL HANG)
(x2)



WALL
ANCHOR
(x2)



CONTROLLER
SCREW SET
(x2)



WIRE
TIES
(x1)

INSTALLATION

STEP 1

Mark the drilling holes in your chosen mounting location using the wall-hang bracket.

Make sure your chosen mounting location is structurally sound and free of obstruction.

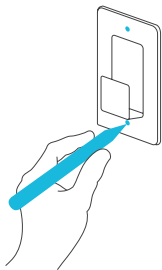

STEP 2

Drill the two holes into your marked locations and apply the wall anchors.

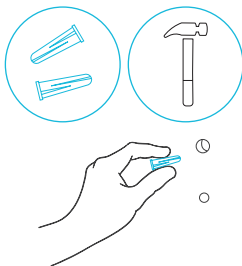

INSTALLATION

STEP 3

Replace the bracket and drill the screws into your wall to secure it.

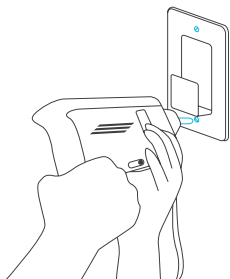

STEP 4

Pull the stand vertically and hook the fan onto the bracket.

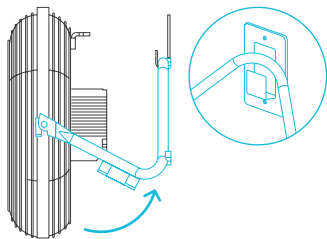

POWERING AND SETUP

STEP 1

Use one of the included UIS M-M extension cords to connect the fan to the wireless receiver.

You may magnetically mount the receiver in the controller slot.

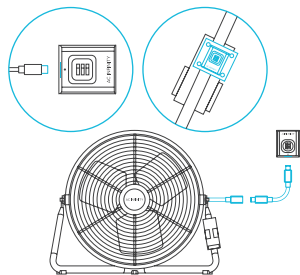

STEP 2

Insert the two AAA batteries into the wireless controller.

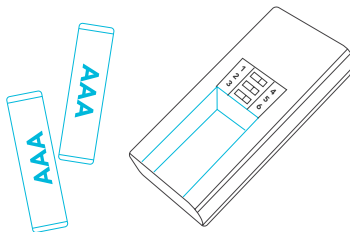

POWERING AND SETUP

STEP 3

Adjust the sliders on the controller and receiver so their numbers match. Close the battery door when you are finished. The receiver's indicator light will flash when connected.

Any number of devices may be controlled using the same controller, as long as the fans' sliders match the controller's.

Any number of controllers may control the same device, as long as the controllers' sliders match the fan's.

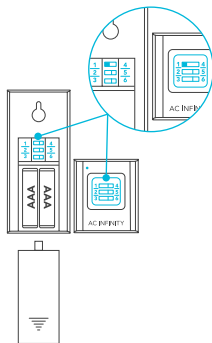

STEP 4

Plug the fan's power cord into an AC power outlet to power the fan.

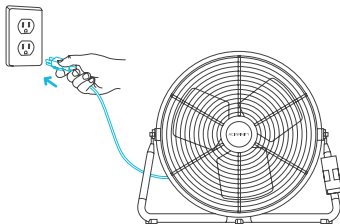

CONTROLLER MOUNTING

STEP 1 — WALL MOUNTING

Locate a spot free of obstruction and secure the anchor into your wall. Twist the wood screw into the anchors.

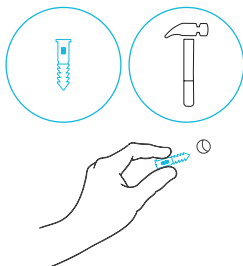

STEP 2 — WALL MOUNTING

Use the mounting hole located on the back of the controller and receiver for wall mount.

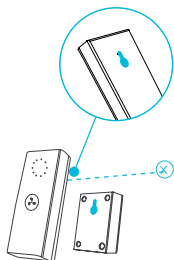

CONTROLLER MOUNTING

MAGNET MOUNTING

Mount the controller on a steel surface using the magnets located next to the mounting hole.

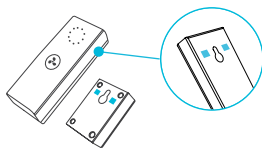
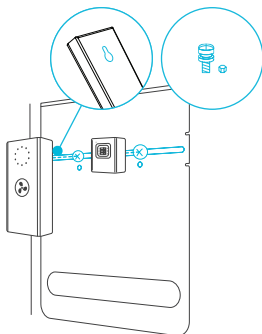

PLATE MOUNTING*

Screw the controller plate bolts into the slot or mounting holes at the upper half of the plate.

Hang the controller and receiver by the bolts using the holes on the backsides.



*Controller plate not included

UIS™ PLATFORM

The UIS™ platform enables you to connect a single central controller with several grow devices simultaneously. By creating this fully integrated system, you can power and program all your devices together or separately for optimized grow tent management.

Your grow system can be regulated using your controller hub or remotely on the AC Infinity app (paired with compatible controllers), where you will have access to automation programming and climate data.

You can also connect your favorite grow light and outlet device to integrate them into the UIS platform using our RJ11/12 adapter and control plug module.

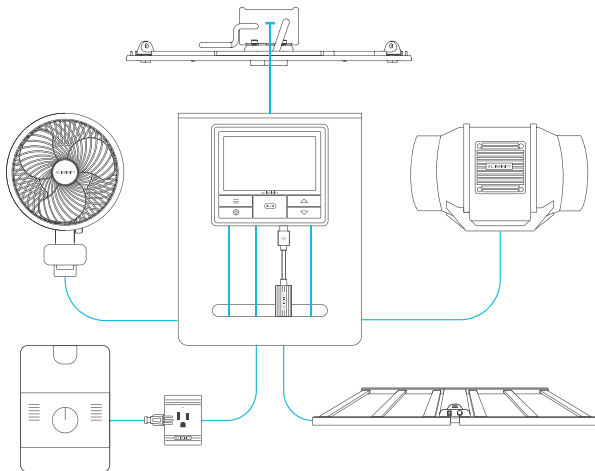

Central controllers, mounting plates, and ventilation devices will be sold separately and may still be in development at the time of your purchase of this product.

UIS™ COMPATIBILITY

MOLEX ADAPTER*

Use the included Molex adapter to plug inline fans with 4-pin Molex connectors into this controller. Plug your fan's Molex connector into the adapter. Then plug the adapter into the controller.

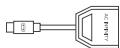

UIS M - 4PIN F
ADAPTER

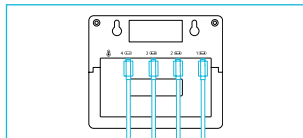

EXTENSION CABLE

Use male-to-male UIS extension cords to connect devices with female UIS ports at an extended range from your controller. Included with UIS-compatible devices.

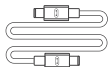

UIS M - M
CORD

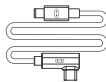

UIS M - M
CLIP FAN CORD

EXPANSION SPLITTER*

The expansion splitter will allow you to connect 4 devices with a single port and can support additional splitters to create up to 3 tiers of expansion ports (up to 64 units supported with the use of 20 splitters). Intended for exclusive use with AC Infinity controllers with UIS ports.

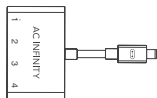

UIS M - F
4 PORT SPLITTER

*Not included

ADDING MORE DEVICES

DAISY-CHAINING

Each of the included controller's ports can support up to 20 devices using a daisy-chain adapter (not included). All devices must be from the same series but can be of differing sizes.

Plug the male end of the daisy-chain adapter into your device.

Connect your UIS controller to the daisy-chain adapter's INPUT port using a M-M connector cord. Using an extension cord, attach the daisy-chain adapter's OUTPUT port to another adapter's INPUT port. You can also link the OUTPUT port to another UIS device to end the chain.

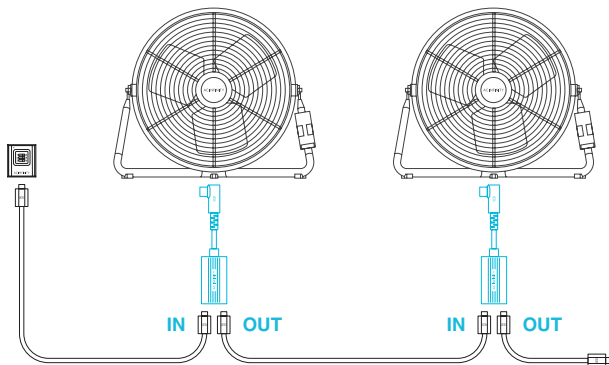
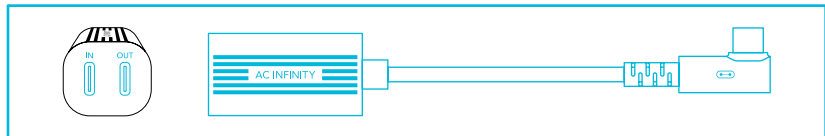

PROGRAMMING

LIGHT INDICATOR

Features ten LED lights to signify the current level. The LEDs will briefly light up before shutting off. Pressing the button will light up the LEDs.

ON

Press the button will turn your device on at level 1. Continue pressing it to cycle through the ten device levels.

OFF

Hold the button to turn your device off. Press it again to return the device level back to the last setting.

Pressing the button after speed 10 will also turn your device off.

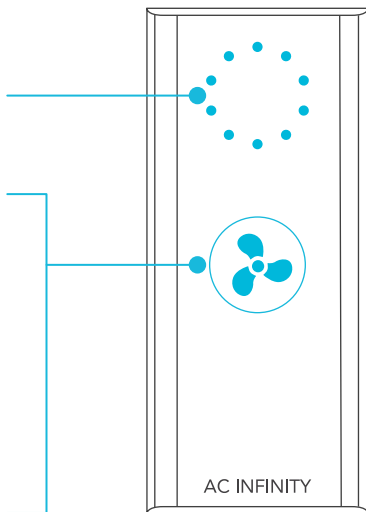

AC INFINITY PRODUCTS

Inline Fans

The CLOUDLINE series is a line of duct fans designed to quietly ventilate AV rooms and closets, as well as various DIY air circulation and exhaust projects. Features a thermal controller with intelligent programming that will automatically adjust duct fan speeds in response to changing temperatures.



Shutter Fans

The AIRLIFT series is a line of shutter exhaust fans designed to expel heat, moisture, odor, and dust from spaces like greenhouses, garages, attics, and sheds. It features an intelligent controller that includes temperature and humidity programming, adjustable fan speed controls, a timer, and an alarm system.

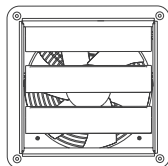

Crawlspace Fans

The AIRTITAN series is a line of weather-proof fans designed to provide ventilation, as well as odor and moisture control for crawl spaces and basements. Features a smart controller to respond to shifts in temperature and humidity.

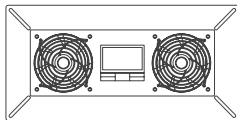

Discover the latest innovations in environmental controls at acinfinity.com

WARRANTY

This warranty program is our commitment to you, the product sold by AC Infinity will be free from defects in manufacturing for a period of two years from the date of purchase. If a product is found to have a defect in material or workmanship, we will take the appropriate actions defined in this warranty to resolve any issues.

The warranty program applies to any order, purchase, receipt, or use of any products sold by AC Infinity or our authorized dealerships. The program covers products that have become defective, malfunctioned, or expressively if the product becomes unusable. The warranty program goes into effect on the date of purchase. The program will expire two years from the date of purchase. If your product becomes defective during that period, AC Infinity will replace your product with a new one or issue you a full refund.

The warranty program does not cover abuse or misuse. This includes physical damage, submersion of the product in water, incorrect installation such as wrong voltage input, and misuse for any reason other than intended purposes. AC Infinity is not responsible for consequential loss or incidental damages of any nature caused by the product. We will not warrant damage from normal wear such as scratches and dings.

Contact our dealers department at dealers@acinfinity.com or (626) 838-4656 for more information about our dealers and distributors program. Contact our customer service department at support@acinfinity.com or 626-923-6399 for product and warranty assistance. Our business hours are Monday through Friday, 9:00 am to 5:00 pm PST.



If you have any issues with this product, contact us and we'll happily resolve your problem or issue a full refund!

COPYRIGHT © 2023 AC INFINITY INC. ALL RIGHTS RESERVED

No part of the materials including graphics or logos available in this booklet may be copied, photocopied, reproduced, translated or reduced to any electronic medium or machine readable form, in whole or in part, without specific permission from AC Infinity Inc.

www.acinfinity.com