

AC INFINITY

SUNCORE

SEEDLING HEATING MAT

USER MANUAL

WELCOME

Thank you for choosing AC Infinity. We are committed to product quality and friendly customer service. If you have any questions or suggestions, please don't hesitate to [contact](#) us. Visit www.acinfinity.com and click contact for our contact information.

EMAIL

support@acinfinity.com

WEB

www.acinfinity.com

LOCATION

Los Angeles, CA

MANUAL CODE SC2310X1

PRODUCT

SUNCORE A1
SUNCORE S3
SUNCORE A5
SUNCORE A7
SUNCORE A3X2
SUNCORE H1
SUNCORE H3
SUNCORE H5
SUNCORE H7
SUNCORE H3X2

MODEL

AC-SMA1
AC-SMS3
AC-SMA5
AC-SMA7
AC-SMA3X2
AC-SMH1
AC-SMH3
AC-SMH5
AC-SMH7
AC-SMH3X2

UPC-A

819137021167
819137023468
819137021181
819137021198
819137022133
819137024533
819137024540
819137024557
819137024564
819137024571

MANUAL INDEX

Manual Index	Page 5
Product Warning	Page 6
Key Features	Page 7
Product Contents	Page 8
Powering and Setup	Page 9
Controller Mounting	Page 10
Starter Guide	Page 12
Programming	Page 15
Other AC Infinity Products	Page 18
Warranty	Page 19

PRODUCT WARNING



TO REDUCE THE RISK OF FIRE, ELECTRIC SHOCK, OR INJURY TO PERSONS, OBSERVE THE FOLLOWING:

1. Read all instructions before installing and using this product.
2. Ensure your power source conforms to the electrical requirements of this product.
3. This product is not intended for users who lack experience with and knowledge of this product, children, or those with reduced physical, sensory, or mental capabilities, unless under supervision by a qualified individual responsible for their safety.
4. Check your local code restrictions for additional safety measures that may be needed for a proper code compliant installation.
5. If you are unfamiliar or have doubts about performing this product's installation, seek the services of a qualified, trained, and licensed professional. Inappropriate installation will void this product's warranty.
6. If the polarized plug doesn't fit, flip it and try again. If it still doesn't fit, contact us or an electrician for assistance. DO NOT trim, cut, or otherwise modify the polarized plug.
7. This product must not be used in potentially hazardous locations such as flammable, explosive, chemical-laden, or wet atmospheres.
8. Do not cover power cords with rugs or other fabric materials, or place heated objects underneath the mat.
9. Do not use this heating mat outdoors or submerge it in water.
10. Do not depend on the on/off programming as the sole means of shutting power from this product. Unplug the power cord before installing, servicing, or moving this product.
11. Do not use this mat while its cord is damaged, if it malfunctions, if it has been dropped, or if it is damaged in any manner.

KEY FEATURES

STORAGE BAG

A water resistant bag made with nylon fabric and drawstring opening to easily store your seedling mat.



HEAT DISTRIBUTION

Improve germination and rooting by emitting a steady stream of heat that insulates your seed tray.

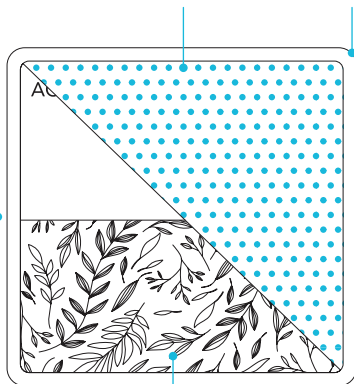

WATER-RESISTANT MAT

IP67-rated heating pad utilizes multiple layers of highly durable PVC matting to prevent damage from liquids and dust.

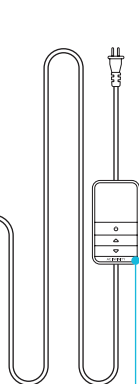

HIGHLY RESILIENT

Durable build with material designed to last under extreme temperature and climate conditions.

HEATING FILM

Lined with far infrared film to provide uniform heating distribution throughout your seedling trays.

SMART CONTROLLER

H-series models include a controller to set the exact heating level you want for accelerated germination.

*Shown: H-Series

PRODUCT CONTENTS

A-SERIES / SUNCORE S3 MODELS



SEEDLING
MAT
(x1)

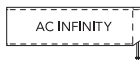

STORAGE
MAT COVER
(x1)



MACHINE
SCREW SET
(x2)



WOOD
SCREWS
(x2)

H-SERIES MODELS



SEEDLING
MAT
(x1)

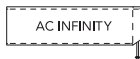

STORAGE
MAT COVER
(x1)



WALL-HANG
WOOD SCREWS
(x1)

*AC-SMA3X2 and AC-SMH3X2 models includes two units of seedling mats, storage mat covers, and dual screw sets.

POWERING AND SETUP

STEP 1

Unroll your seedling mat flat onto the ground.

Do not allow it to overlap onto itself.

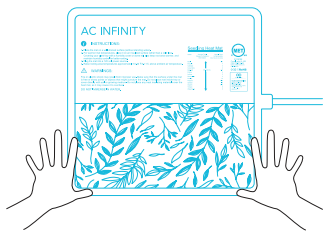

STEP 2

Plug the power cord into an AC power outlet to power your seedling mat.

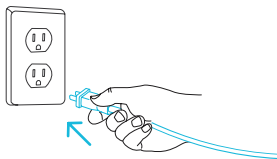

CONTROLLER MOUNTING

A-SERIES / SUNCORE S3 MODELS

STEP 1

Locate a spot free of obstruction. Use the controller bracket to set your desired position. Mark the two mounting holes.

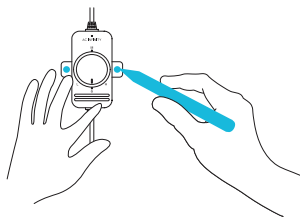

STEP 2

Drill holes into the marked locations.

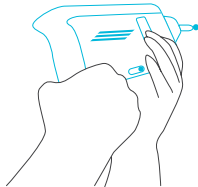

STEP 3

Align the controller bracket with the mounting holes. Secure it to the surface with the two woods screws or the two machine screws and nuts included with your seedling mat.

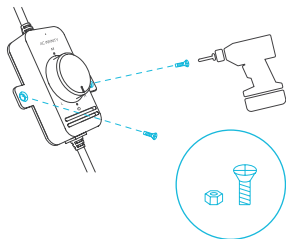

CONTROLLER MOUNTING

H-SERIES

STEP 1

Locate a spot free of obstruction and secure the anchor into your wall. Twist the wood screw into the anchors.

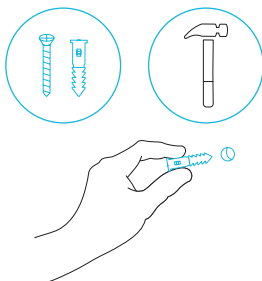

STEP 2

Hang the controller by the screw using the hole located on its backside.

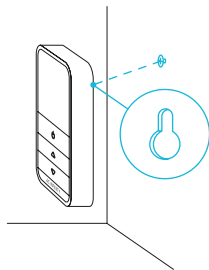

STARTER GUIDE

GROWING SEASONS

Use your seedling mat to get a head start on the gardening season. Start the germination process during late winter or spring, especially if you are in a colder region.

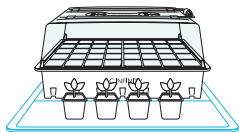

GERMINATION

Different seeds require different temperatures to germinate. Before you begin, refer to your seed package and the table on the seedling mat for recommended temperature settings.

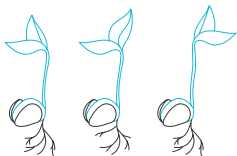

TEMPERATURE

If your seed packet does not specify an ideal temperature, keep the temperature between 65°F and 75°F (18-24°C).

Note: Make sure to also keep track of the ambient room temperature; along with your local weather, this can also affect your germination process.

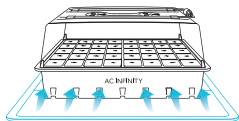

Shown: Propagation Kit (AC-HDL5)

STARTER GUIDE

HUMIDITY

Humidity domes (sold separately) and plastic covered pots* can be used alongside your seedling mat to introduce moisture, which help accelerate plant growth.

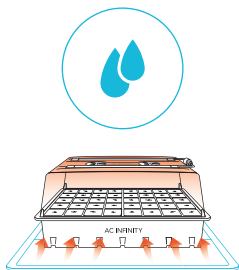

SOWING SEEDS

Sow 2-3 seeds per cell; not every seed is guaranteed to germinate. Cover the seeds completely with your grow media. Set a dome over the tray.

Place the seed tray on your seedling mat and turn it on to begin heating.

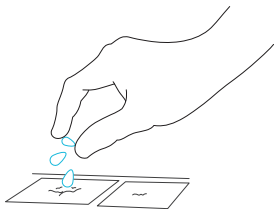

*Not included

STARTER GUIDE

LIGHTING OPTIONS

You may utilize natural lighting coming through a south-facing window as it is available. Rotate the seed tray daily.

You may also use grow lights to help develop your seedlings. Exercise caution when using this lighting source, as this may dry out your soil and overheat your seedlings' roots.

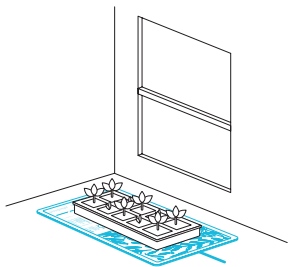

WATERING YOUR SEEDS

Add starter mix or pellets to your seed tray and water it before using your seedling mat, drying off any excess moisture. It should appear dark brown. Water the starter mix/pellets as needed whenever it appears light brown.

Prop your dome up to 1.5 inches when your seeds germinate. You may remove the seed tray from its dome and your seedling mat when about half your seeds have germinated.

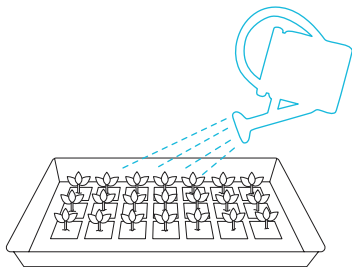

PROGRAMMING

A-SERIES / SUNCORE S3 MODELS

LIGHT INDICATOR

When the controller is turned on and receiving power, the LED at the top of the controller will light up to show it is on.

ON

Turn the knob clockwise until you hear and feel a click to turn on your seedling mat.

OFF

Turn the knob counterclockwise from ON until you hear and feel a click to turn off your seedling mat.

HEAT CONTROL

Turning the knob will gradually adjust the heating level between low, medium, and high.

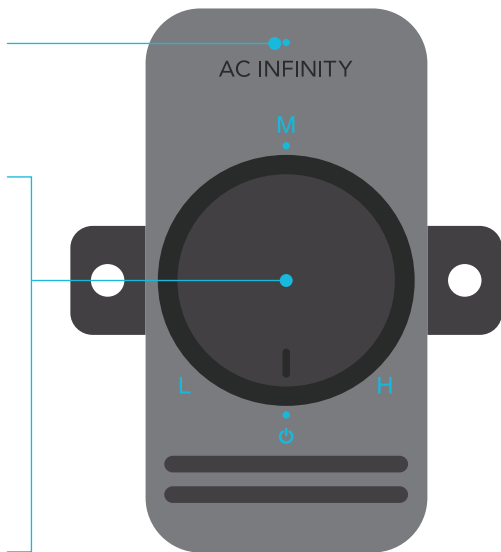

PROGRAMMING

H-SERIES

1. POWER BUTTON

Turns your seedling mat ON and OFF. Hold down the power button for 10 seconds to reset the controller to factory settings.

2. UP/DOWN BUTTONS

Adjusts the value of your seedling mat's surface temperature setting. The up button increases and down button decreases the setting. Hold both buttons to switch between Fahrenheit (F°) and Celsius (C°).

3. SENSOR TEMPERATURE

Displays the ambient temperature the sensor is detecting.

4. SETTING TEMPERATURE

Displays your surface temperature setting.

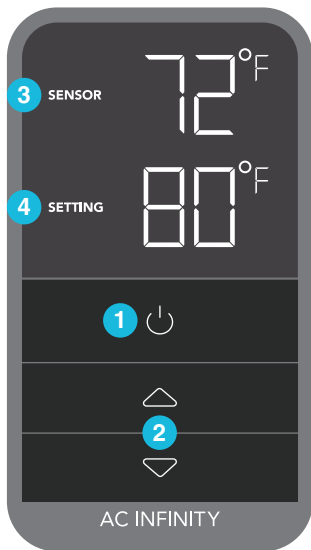

PROGRAMMING

H-SERIES

AUTOMATIC HEATING

Your seedling mat will continuously emit heat if the setting temperature is greater than the sensor temperature.

If the sensor temperature meets or exceeds the setting temperature, your seedling mat will not emit heat until the former falls below the latter.

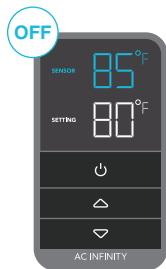
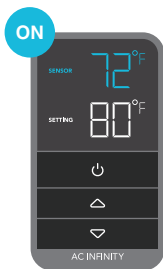

RAISING TEMP. IN COLD SPACES

When using your seedling mat in colder spaces, its temperature may not be able to reach your setting temperature.

The difference in temperature will work against its ability to adequately warm up to your desired heating level.

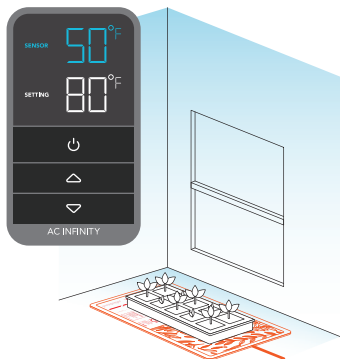

AC INFINITY PRODUCTS

Humidity Dome

The humidity dome is designed to maintain moisture levels to create the ideal environment for seed germination. Each kit includes a base tray and seedling tray with a dome that is built with adjustable vents to control humidity levels. Height extender also included to provide a higher ceiling for propagation applications.

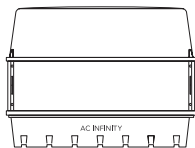

Grow Lights

The IONBEAM series is a line of grow lights designed to simulate outdoor lighting to improve and accelerate your plant's photosynthesis. Features the latest Samsung LM301H diodes to efficiently produce full-spectrum lighting, as well as magnetic mounting to allow for inter-canopy lighting.

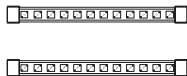

Thermo-Hygrometers

The CLOUDCOM series is a line of smart thermo-hygrometers designed to accurately detect and measure your space's temperature and relative humidity. Features a bright backlit screen and desktop, wall, or magnetic mounting options to place and display anywhere. Select models include a corded, Swiss-made sensor probe by Sensirion AG for spot detection.

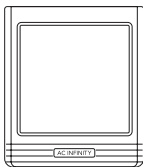

Discover the latest innovations in environmental controls at acinfinity.com

WARRANTY

This warranty program is our commitment to you, the product sold by AC Infinity will be free from defects in manufacturing for a period of two years from the date of purchase. If a product is found to have a defect in material or workmanship, we will take the appropriate actions defined in this warranty to resolve any issues.

The warranty program applies to any order, purchase, receipt, or use of any products sold by AC Infinity or our authorized dealerships. The program covers products that have become defective, malfunctioned, or expressly if the product becomes unusable. The warranty program goes into effect on the date of purchase. The program will expire two years from the date of purchase. If your product becomes defective during that period, AC Infinity will replace your product with a new one or issue you a full refund.

The warranty program does not cover abuse or misuse. This includes physical damage, submersion of the product in water, incorrect installation such as wrong voltage input, and misuse for any reason other than intended purposes. AC Infinity is not responsible for consequential loss or incidental damages of any nature caused by the product. We will not warrant damage from normal wear such as scratches and dings.

Contact our dealers department at dealers@acinfinity.com or (626) 838-4656 for more information about our dealers and distributors program. Contact our customer service department at support@acinfinity.com or 626-923-6399 for product and warranty assistance. Our business hours are Monday through Friday, 9:00 am to 5:00 pm PST.



If you run into any issues with this product, contact us and we'll happily issue a replacement or a full refund!

COPYRIGHT © 2023 AC INFINITY INC. ALL RIGHTS RESERVED

No part of the materials including graphics or logos available in this booklet may be copied, photocopied, reproduced, translated or reduced to any electronic medium or machine readable form, in whole or in part, without specific permission from AC Infinity Inc.

www.acinfinity.com