

AC INFINITY

THERMOFORGE SERIES

ENVIRONMENTAL VPD HEATER

USER MANUAL

WELCOME

Thank you for choosing AC Infinity. We are committed to product quality and friendly customer service. If you have any questions or suggestions, please don't hesitate to [contact](#) us. Visit www.acinfinity.com and click contact for our contact information.

EMAIL

support@acinfinity.com

WEB

www.acinfinity.com

LOCATION

Los Angeles, CA

MANUAL CODE SFT2311X1

PRODUCT

THERMOFORGE T3
THERMOFORGE T7

MODEL

AC-SFT3
AC-SFT7

UPC-A

819137024489
819137024502

MANUAL INDEX

Manual Index	Page 5
Product Warning	Page 6
Key Features	Page 10
Product Contents	Page 11
Installation	Page 12
Powering and Setup	Page 13
Cleaning	Page 15
UIS™ Platform	Page 16
Connecting to UIS™ Controllers	Page 17
Programming	Page 18
Other Settings	Page 33
FAQ	Page 35
Other AC Infinity Products	Page 36
Warranty	Page 37

PRODUCT WARNING



IMPORTANT SAFETY INSTRUCTIONS

PLEASE READ ALL INSTRUCTIONS BEFORE USING THIS HEATER AND KEEP IT FOR FUTURE REFERENCE.

When using electrical appliances, basic precautions should always be followed to reduce the risk of fire, electric shock, and injury to persons, including the following:

1. Read all instructions before installing and using this product.
2. Use this product only as described in this manual. Any other use not recommended by the manufacturer may cause fire, electric shock, injury to persons or other damage to property.
3. This heater is hot when in use. To avoid burns, do not let bare skin touch hot surfaces. Use handles when moving this heater.
4. Place this product at least 3 feet away on all sides from walls, outlets, furniture, pillows, bedding, papers, clothes, curtains and other objects that may cause or catch fire. Do not place it near any flammable objects that may fall off and catch fire.
5. This product is not intended for users who lack experience with and knowledge of this product, children, or those with reduced physical, sensory, or mental capabilities, unless under supervision by a qualified individual responsible for their safety.
6. Do not depend on the on/off programming as the sole means of shutting power from this product. Unplug the power cord before installing, servicing, or moving this product. Unplug product when it is not in use. Do not yank, strain, or stretch the power cord.
7. Do not operate this product if it malfunctions, has been dropped, or is damaged in any manner. Do not operate this product if its cord malfunctions or is damaged in any manner. Contact our customer service for support.
8. Do not use this product outdoors, in direct sunlight, or expose it to weather or elements.
9. This product must not be used in potentially hazardous locations such as flammable, explosive, chemical-laden, or wet atmospheres. This includes areas containing gasoline, paint, and additional flammable liquids.

PRODUCT WARNING



10. Do not handle any part of this product or plug with wet hands. Suitable for dry locations ONLY. This product is not intended for use in bathrooms, laundry areas, or similar indoor locations. Never place this product where it may fall into a bathtub or other wet environments. Do not use or store this product where it may get wet, including but not limited to, surrounding areas of baths, showers, or swimming pools.
11. Do not cover power cords with rugs or other fabric materials. Do not route cords under furniture or appliances. The cord should not hang over edges or be placed where it can be bent or closed in doors. Place this product near an easily accessible outlet so the product can be unplugged quickly during an emergency.
12. Plug this product directly into a wall outlet. Never use with an extension cord or relocatable power tap (outlet/power strip). Do not use this product on a surge-protected unit or Ground Fault Circuit Interrupted (GFCI) outlet. Do not yank, strain, stretch, or wet the power cord.
13. Do not insert or allow fingers or foreign objects to enter any ventilation or exhaust openings as it may cause electric shock, fire, or damage to this product. Do not block or tamper with this product in any manner while it is in operation.
14. To prevent a possible fire, do not block air intake or exhaust openings in any manner. Do not use this product on soft surfaces, such as beds, where openings may become blocked. Do not put any object into the inlet grill or the exhaust opening as this may cause an electric shock or fire, or damage this product.
15. To prevent overload and blown fuses, be sure that no other appliance is plugged into the same outlet or into another outlet wired into the same circuit.
16. Never ignore signs of an electrical problem, such as: warn outlet cover plates, sparks when plugging or operating, lights flickering/dimming during operation. Immediately turn off and unplug this product if any such problems are noticed. Contact a qualified electrician to investigate possible causes before operating this product again.
17. It is normal for the plug and cord to feel warm to the touch. A plug or cord that becomes hot to the touch or becomes distorted in shape may be a result of a worn electrical outlet. Worn outlets or receptacles should be replaced prior to further use of this product. Plugging this product into a worn outlet may result in overheating of the power cord or fires.

PRODUCT WARNING



18. The output of this product may vary and its temperature may become intense enough to burn exposed skin. Use of this product is not recommended for persons with reduced sensitivity to heat or an inability to react to and avoid burns.
19. Do not place this product on a soft, elevated, or unstable surface, or in any location where it may fall over or air intakes or exhaust can be blocked in any manner.
20. Do not tilt, incline, or lay this product on its side or back.
21. Be sure that the plug is fully inserted into an appropriate outlet. Please remember that outlets also deteriorate due to aging and continuous use: check periodically for signs of overheating or deformations as evidenced by the plug. Do not use the outlet and contact a qualified electrician.
22. Make sure that no pieces of polystyrene or other packaging material have been left between elements of this product. It may be necessary to pass over this product with a vacuum cleaner. Dispose of all packaging and product materials in an environmentally responsible manner.
23. Choking Hazard - this product may contain small parts. Keep away from children. If small parts are swallowed, seek medical attention at once.
24. Prior to cleaning, storage, or any time when this product is not in use, turn off the power and unplug the cord to allow it to cool. Clean this product regularly, only as instructed in this manual. Do not use gasoline, thinners, solvents, ammonias, or other chemicals for cleaning.
25. There may be a trace of smoke or odor when this product is first operated. This indicates that a drop of oil fell on the heating coil during the manufacturing process. It will quickly evaporate and should not reoccur.
26. IMPORTANT - This product has a polarized plug (one blade is wider than the other). To reduce the risk of electric shock, this plug is intended to fit in a polarized outlet only one way. If the plug does not fit fully in the outlet, reverse the plug. If it still does not fit, contact a qualified electrician. Do not attempt to tamper with this safety feature.

PRODUCT WARNING



DO NOT attempt to repair this product yourself!

All service and/or repairs must be done by an authorized technician and/or electrician. Contact our customer service department at support@acinfinity.com or **626-923-6399** for product and warranty assistance.

**DANGER - High temperatures may be generated under certain abnormal conditions.
Do not partially or fully cover or obstruct the front of this heater.**

READ AND SAVE THESE INSTRUCTIONS.

KEY FEATURES

ACTIVE MONITORING

Features automation controls to activate your heater based on temperature and VPD triggers, timers, and cycles.

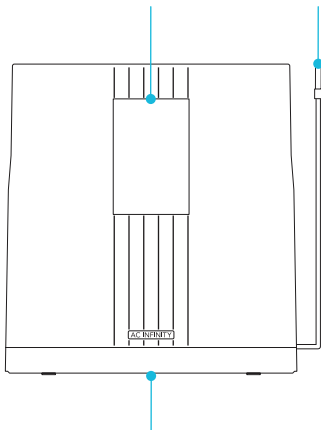

CORD MANAGEMENT

Hidden compartment allows extended cords to be placed out of sight for maximum efficiency and convenience.

PRECISE DETECTION

Thermal alloy sensor tracks shifts in climate and captures up-to-the-second readings for total environmental control.

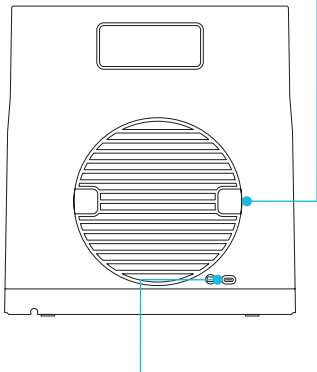

UIS™ COMPATIBLE

Connects with UIS controllers for automations and schedule programming to create the ideal grow environment.

PWM CONTROL

Offers 10 heat and fan levels while delivering an energy-efficient performance with reduced motor noise.

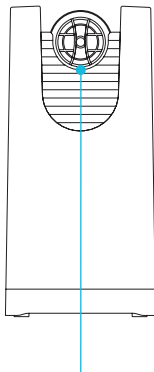

TARGETED HEATING

Flexible duct tubing enables focused heat distribution within your growing environment.

PRODUCT CONTENTS

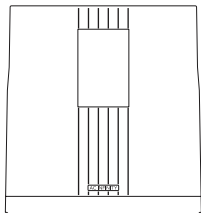

SPACE
HEATER
(x1)



DUCT
EXTENSION
(x1)

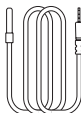

SENSOR
PROBE
(x1)

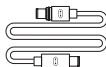

UIS EXTENSION
CORD (M-M)
(x1)



HOOK AND
LOOP TIE
(x4)

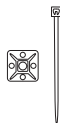

PROBE
MOUNT
(x4)

INSTALLATION

STANDARD INSTALLATION

Place your heater outside of your grow tent.

Route the duct tube through the lowest duct port available and into your grow tent.

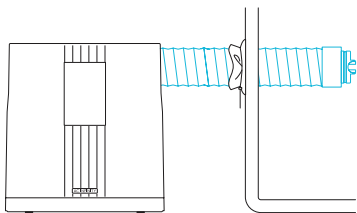

DUCT EXTENSION

You may insert the end of your heater's duct tube into the duct extension to extend its reach.

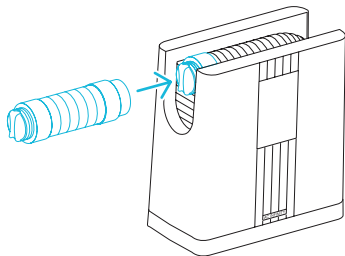

POWERING AND SETUP

STEP 1

Plug the sensor probe into the 3.5mm jack located at the back of your heater.

Route the probe head to your plant's canopy for the most accurate readings.

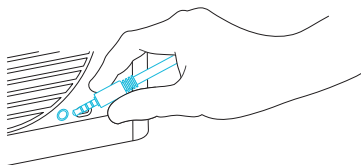

STEP 2

Plug your heater's power plug into an outlet to power it.

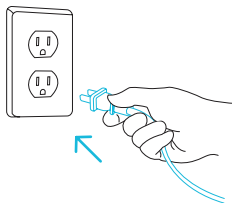

POWERING AND SETUP

CORD MANAGEMENT

You may wrap the power cord around the spool hidden underneath the heater as needed.

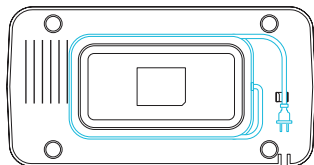

CLEANING

STEP 1

Unplug your heater.

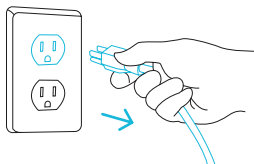

STEP 2

Twist the intake vent cap off of your heater.

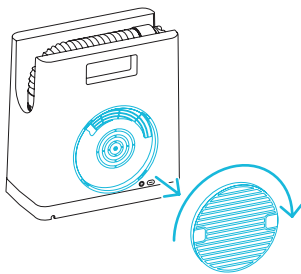

STEP 3

Wipe off any dust and debris from the grille and vent cap using a damp cloth. Set aside to dry as needed.

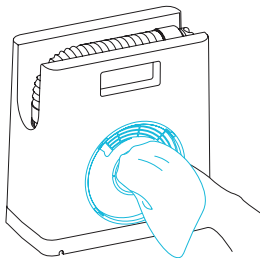

UIS™ PLATFORM

The UIS™ platform enables you to connect a single central controller with several grow devices simultaneously. By creating this fully integrated system, you can power and program all your devices together or separately for optimized grow tent management.

Your grow system can be regulated using your controller hub or remotely on the AC Infinity app (paired with compatible controllers), where you will have access to automation programming and climate data.

You can also connect your favorite grow light and outlet device to integrate them into the UIS platform using our RJ11/12 adapter and control plug module.

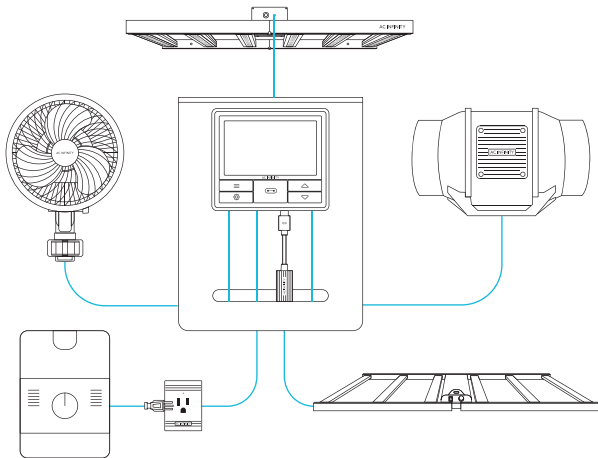

Grow devices will be sold separately and may still be in development at the time of your purchase of this product.

CONNECTING TO UIS™



THERMOFORGE heaters can connect with any UIS controller (sold separately) as part of an integrated system using the included UIS extension cord.

EXTENSION CABLE

Use the included UIS M-M extension cord to connect your heater to your UIS controller.

Plug the UIS connector with the gasket end into your heater. The gasket is specially designed to protect against liquids and dust.

Your UIS controller will override all onboard settings, assume control (parameters must be adjusted on the controller), and shut off your heater's display and touch functions when connected in this manner. The sensor probe plugged into your controller will override the heater's sensor

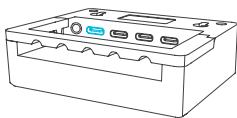
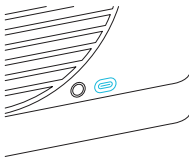
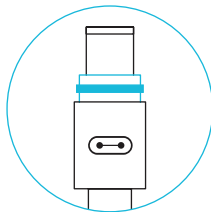

PROGRAMMING

1. MODE BUTTON

Cycles through the controller's modes: OFF, ON, AUTO, VPD, TIMER TO OFF, and CYCLE (ON and OFF).

2. UP/DOWN BUTTONS

Adjusts the value of your current mode. The up button increases and down button decreases the setting. Hold both to reset values to OFF/Default.

3. SETTING BUTTON

Cycles through the controller's settings: °F / °C, CALIB. T° / H%, and LEAF OFFSET.

4. PROBE TEMPERATURE

Displays the current temperature that the probe is detecting. Shows "--" if no probe is plugged in. Includes a trend indicator that signals a rise, stability, or fall in temperature within the last hour.

5. PROBE VPD

Displays the current VPD that the probe is detecting (in kPa). Shows "--" if no probe is plugged in. Includes a trend indicator that signals a rise, stability, or fall in VPD within the last hour.

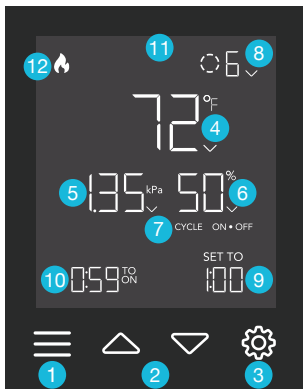

6. PROBE HUMIDITY

Displays the current humidity that the probe is measuring. Shows "--" if no probe is plugged in. Includes a trend indicator that signals a rise, stability, or fall in humidity within the last hour.

7. CONTROLLER MODE

Displays the controller's current mode. Pressing the mode button cycles through the available modes.

8. CURRENT LEVEL

Displays the current setting. Includes a trend indicator that signals if the setting is currently rising, falling, or holding steady.

9. USER SETTING

Displays the value of your current mode. Use the up or down buttons to adjust the value.

10. COUNTDOWN

Displays the countdown of the TIMER TO OFF, or CYCLE Mode that activates or deactivates your heater. TO ON shows the amount of time left before it turns on. TO OFF shows the amount of time left before it turns off.

11. ALERT ICONS

Displays alerts and statuses of the controller, including the controller lock, CLIMATE alert, and TIMER alert.

12. FUNCTION MODE

Displays which function your heater is in between HEAT and FAN.

PROGRAMMING

HEAT FUNCTION

CONTROLLER MODES

Holding the MODE and SETTING buttons for 3 seconds while in any mode or setting will switch your heater between the HEAT and FAN functions. This switching is disabled if the controller is locked.

Pressing the mode button will cycle through the controller's available programming modes: OFF, ON, AUTO, VPD, TIMER TO OFF, CYCLE (On and Off).

OFF MODE

Your heater will not run while in this mode. The OFF Mode setting also serves as the minimum level the other modes will run at while triggered OFF.

MINIMUM LEVEL

Your heater will run at the level set in OFF Mode, as the minimum level, when triggered to turn OFF. These other modes include the AUTO Mode, VPD Mode, TIMER TO OFF Mode, and CYCLE Mode.

It will run continuously until triggered ON, at which point it will run at the level set in ON Mode.

If you want your heater to turn off completely when they're triggered to be OFF, set the OFF Mode level to zero.

OFF MODE

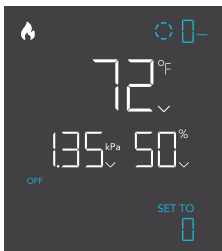

MINIMUM LEVEL

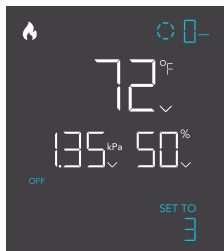

PROGRAMMING

HEAT FUNCTION

ON MODE

Your heater will actively run at the level set here, regardless of the probe's reading. The ON Mode setting also serves as the maximum level the other modes will run at.

MAXIMUM LEVEL

Your heater will run at the level set in ON Mode, as the maximum level, when triggered ON, as well as in the AUTO Mode, VPD Mode, TIMER TO OFF Mode, and CYCLE Mode.

Do not set the ON Mode figure to zero or your heater will turn off when it's triggered ON in all modes.

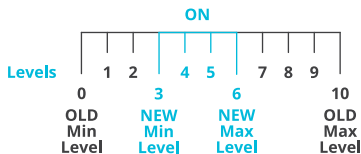

PROGRAMMING

HEAT FUNCTION

AUTO MODE (LOW TEMPERATURE TRIGGER)

Pressing the up or down button sets the low temperature trigger. Your heater will activate if the probe's reading meets or falls below this threshold.

Once triggered, your heater will gradually ramp up to the level set in ON Mode. If the probe's reading rises above this trigger point, your heater will gradually slow down to a stop or at the level set in OFF Mode.

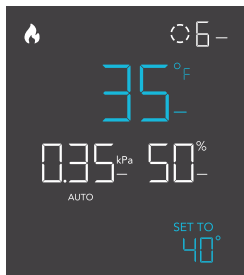

Set a trigger point to OFF if not in use, by holding down the up and down button. If there is a level set in OFF Mode other than zero, your heater will run at that level when triggered to turn off.

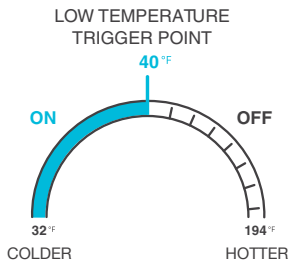

PROGRAMMING

HEAT FUNCTION

VPD MODE (LOW VPD TRIGGER)

Pressing the up or down button sets the low VPD trigger. Your heater will activate if the probe's reading meets or falls below this threshold.

Once triggered, your heater will gradually ramp up to the level set in ON Mode. If the probe's reading falls below this trigger point, your heater will gradually slow down to a stop or at the level set in OFF Mode.

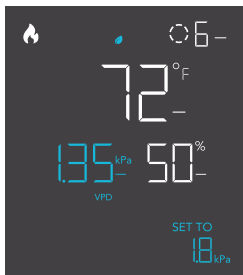

Set a trigger point to OFF if not in use, by holding down the up and down button. If there is a level set in OFF Mode other than zero, your heater will run at that level when triggered to turn off.

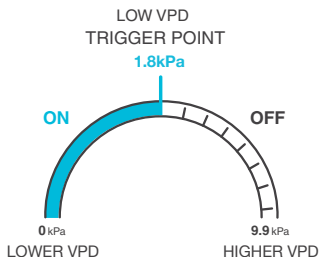

PROGRAMMING

HEAT FUNCTION

TIMER TO OFF MODE

Pressing the up or down button sets a countdown time. During the countdown, your heater will be set to ON. Once the timer ends, your heater will trigger to turn off. If there is a level set in OFF Mode, your heater will run at that level after the end of the countdown.

The countdown will begin if no buttons are pressed for 5 seconds. The time left on the countdown is shown on the lower right corner of the display above the setting. Leaving the TIMER Mode while the countdown is running will pause it until you return to this mode.

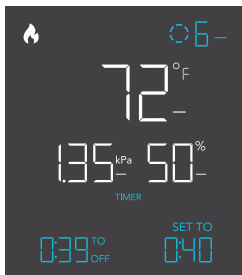

TIMER TO OFF
(COUNTDOWN END POINT)

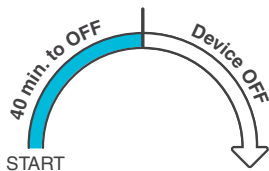

PROGRAMMING

HEAT FUNCTION

CYCLE MODE (ON AND OFF)

Sets an on duration and an off duration for your heater to cycle through continuously. Press the up or down button to first set a duration for it to activate. Then press the mode button again and set a duration for your heater to deactivate.

When your heater is activated, it will run at the level set in ON Mode. When it is deactivated, it will run at the level set in OFF Mode.

The countdown will begin if no buttons are pressed for 5 seconds. The time left on the countdown before the next ON or OFF phase is displayed below the current level. Leaving the CYCLE Mode while the countdown is running will pause it until you return to this mode.

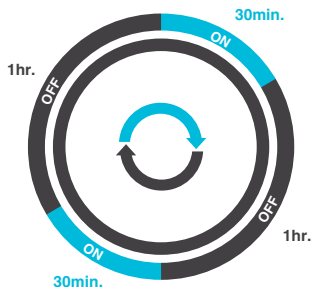

If there is a level set in OFF Mode other than zero, your heater will run at that level when triggered to turn off.

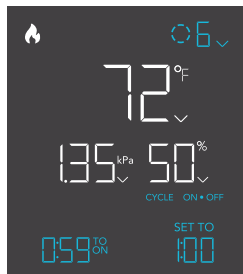
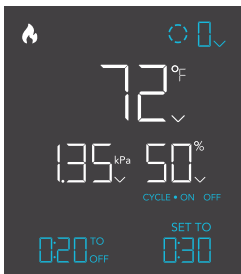

PROGRAMMING

FAN FUNCTION

CONTROLLER MODES

Holding the MODE and SETTING buttons for 3 seconds while in any mode or setting will switch your heater between the HEAT and FAN functions. This switching is disabled if the controller is locked.

Pressing the mode button will cycle through the controller's available programming modes: OFF, ON, TIMER TO OFF, CYCLE (On and Off).

OFF MODE

Your heater will not run while in this mode. The OFF Mode setting also serves as the minimum level the other modes will run at while triggered OFF.

MINIMUM LEVEL

Your heater will run at the level set in OFF Mode, as the minimum level, when triggered to turn OFF. These other modes include the TIMER TO OFF Mode and CYCLE Mode.

It will run continuously until triggered ON, at which point it will run at the level set in ON Mode.

If you want your heater to turn off completely when they're triggered to be OFF, set the OFF Mode level to zero.

OFF MODE

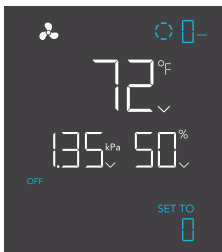

MINIMUM LEVEL

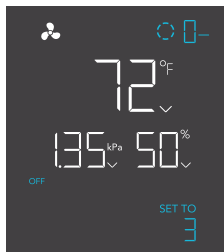

PROGRAMMING

FAN FUNCTION

ON MODE

Your heater will actively run at the level set here, regardless of the probe's reading. The ON Mode setting also serves as the maximum level the other modes will run at.

MAXIMUM LEVEL

Your heater will run at the level set in ON Mode, as the maximum level, when triggered ON, as well as in the TIMER TO OFF Mode and CYCLE Mode.

Do not set the ON Mode figure to zero or your heater will turn off when it's triggered ON in all modes.

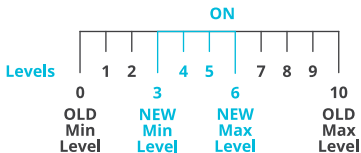
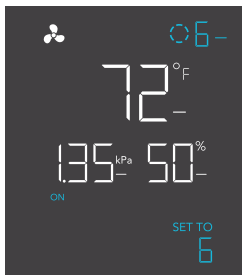

PROGRAMMING

FAN FUNCTION

TIMER TO OFF MODE

Pressing the up or down button sets a countdown time. During the countdown, your heater will be set to ON. Once the timer ends, your heater will trigger to turn off. If there is a level set in OFF Mode, your heater will run at that level after the end of the countdown.

The countdown will begin if no buttons are pressed for 5 seconds. The time left on the countdown is shown on the lower right corner of the display above the setting. Leaving the TIMER Mode while the countdown is running will pause it until you return to this mode.

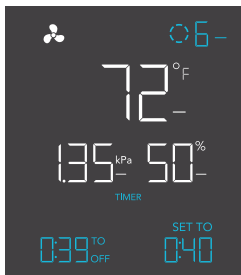

TIMER TO OFF
(COUNTDOWN END POINT)

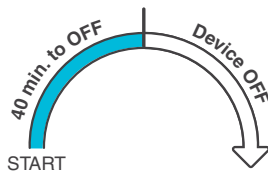

PROGRAMMING

FAN FUNCTION

CYCLE MODE (ON AND OFF)

Sets an on duration and an off duration for your heater to cycle through continuously. Press the up or down button to first set a duration for it to activate. Then press the mode button again and set a duration for your heater to deactivate.

When your heater are activated, it will run at the level set in ON Mode. When your heater is deactivated, they will run at the level set in OFF Mode.

The countdown will begin if no buttons are pressed for 5 seconds. The time left on the countdown before the next ON or OFF phase is displayed below the current level. Leaving the CYCLE Mode while the countdown is running will pause it until you return to this mode.

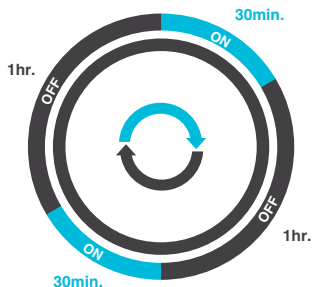

If there is a level set in OFF Mode other than zero, your heater will run at that level when triggered to turn off.

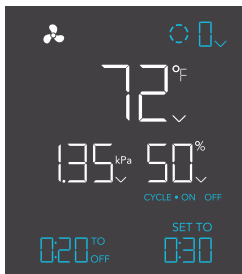

PROGRAMMING

CONTROLLER SETTINGS

Pressing the setting button will cycle through the controller's available settings: °F / °C, CALIB. T° / H%, and LEAF OFFSET.

TOGGLING THE DISPLAY

Lock the controller by holding the setting button.

Press the setting button to turn the display off.
Pressing the setting button again will turn the display back on.

Programs will still run in the background while the LCD screen is off.

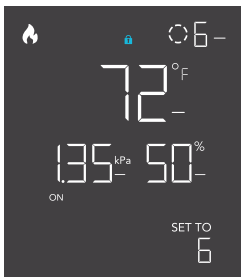

°F/°C SETTING

Changes the displayed units to Fahrenheit or Celsius. Press the up or down button to cycle through F and C. All displayed units will automatically convert when adjusting this setting.

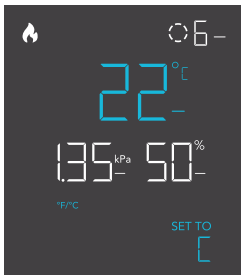

PROGRAMMING

CALIBRATION TEMPERATURE SETTING

Adjusts the temperature reading the sensor probe is measuring. Press the up or down button to increase or decrease the data figure in 1° increments. The calibration cycle ranges from -20°F to 20°F (or -10°C to 10°C) and will be applied to the sensor probe's measurements.

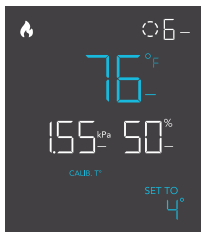

CALIBRATION HUMIDITY SETTING

Adjusts the relative humidity reading the sensor probe is measuring. Press the up or down button to increase or decrease the data figure in 1% increments. The calibration cycle ranges from -10% to 10% and will be applied to the sensor probe's measurements.



CALIBRATION LEAF OFFSET SETTING

Adjusts the VPD reading the sensor probe is measuring. Press the up or down button to increase or decrease the data figure in 1° increments. The calibration cycle ranges from -20°F to 20°F (or -10°C to 10°C) and will be applied to the sensor probe's measurements.

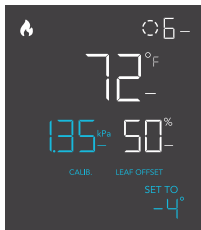

PROGRAMMING

ALERT ICONS

The alert icons are displayed at the top of the screen and will flash when the controller signals an alert, notifying you of any triggered functions or alarms.



ALARM

Flashes and beeps with an alert if the temperature/VPD meet the trigger point set in the app.



AUTO MODE ALERT

Flashes whenever the AUTO Mode trigger activates your heater.



TIMER ALERT

Flashes when a countdown has completed in the TIMER or CYCLE Mode.



VPD ALERT

Flashes whenever the VPD Mode trigger activates your heater.

PROGRAMMING



DISPLAY LOCK ALERT

Displays when you lock the screen. The icon will flash and beep if you attempt to adjust your heater while it is still locked.



FAIL-SAFE

Flashes whenever your heater falls or is tilted past a 15° angle. It will pause programming and its screen will flash until it is back to an upright position.



INTERNAL OVERHEATING

Flashes whenever your heater's internal temperature exceeds 194°F. The heater function and controller buttons will be disabled until the internal temperature cools below 185°F. The fan function will not be disabled during this emergency shutoff.



ENVIRONMENTAL OVERHEATING

Flashes whenever the sensor probe senses a temperature exceeding 140°F. The heater function and controller buttons will be disabled until the temperature cools below 131°F. The fan function will not be disabled during this emergency shutoff.



FAN ALERT

Flashes whenever the fan experiences interference to its functioning. Check your heater for possible issues.

OTHER SETTINGS

SWITCH FUNCTION

Holding the mode and setting buttons for 3 seconds will switch your heater between the HEAT and FAN functions. This switching is disabled if the controller is locked.



FACTORY RESET

Holding the mode, up, and down buttons together for 5 seconds will reset your heater and restore factory settings. This clears all user parameters in each mode and setting.



CONTROLLER LOCK

Holding the setting button will lock your heater in your current mode. While your heater is locked, no parameters may be adjusted, nor will you be able to switch modes or functions. Holding the setting button again will unlock your heater.



HIDE SCREEN

Lock your heater so no settings can be adjusted. See above. Then press the setting button to turn the display off. Pressing it again will turn the display back on. Programs will still run in the background while the LCD screen is off.



OTHER SETTINGS

JUMP TO OFF MODE

Holding the mode button for 3 seconds while in any mode or setting will automatically jump to OFF Mode. This function is disabled if the controller is locked.

HOLD + 

RESET TO OFF/DEFAULT

Holding the up and down buttons together for 2 seconds will reset the value of your current mode or setting to default. In AUTO and VPD Mode, pressing either the up or down button will return to its previous value.

HOLD +  

TOGGLE BUTTON SOUNDS

Hold the mode and up buttons to turn off or on button sounds.

HOLD +  

MUTE ALARMS

Press any button to mute alarms.

PRESS ANY
BUTTON

FAQ

Q: Why does my screen turn off when I connect my heater to a UIS controller?

A: A UIS controller will override your heater's onboard programming. Your device's screen will shut off and you can program your device directly through the smart controller.

Q: When I connect to a smart controller, which sensor probe is active?

A: The sensor probe plugged into your controller will override the heater's sensor.

Q: How should I route my heater's ducting?

A: Set your heater outside of your grow tent and channel the ducting through one of its lower duct ports.

Q: Can I place this heater inside of my grow tent?

A: You may place your heater inside of your grow tent as long as its humidity level does not rise above 65%. Otherwise we recommend keeping your heater outside of your grow tent and directing heat from it using the built-in ducting with duct extension (as needed). See above.

AC INFINITY PRODUCTS

CONTROLLER 69 PRO

The CONTROLLER 69 PRO is the centerpiece of the UIS platform, able to connect with our smart devices including fans and LED grow lights to create the optimal growing environment. Connects with up to four devices to provide independent programming while capable of dynamically adjusting fan speed and brightness intensity levels in response to temperature, humidity, and VPD levels.



Humidifiers

The CLOUDFORGE series is a line of humidifiers designed to produce optimal humidity levels for successful plant growth. The onboard smart controls feature 10 intensity levels, humidity and VPD triggers, timer programming, and more. Includes a corded sensor probe for up-to-the-minute readings and tubing for targeted vapor distribution.

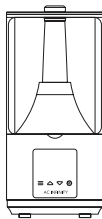

Duct Fans

The CLOUDLINE series is a line of duct fans designed to quietly ventilate AV rooms and closets, as well as various DIY air circulation and exhaust projects. Features a thermal controller with intelligent programming that will automatically adjust duct fan speeds in response to changing temperatures.

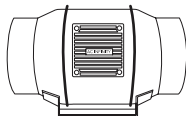

Discover the latest innovations in environmental controls at acinfinity.com

WARRANTY

This warranty program is our commitment to you, the product sold by AC Infinity will be free from defects in manufacturing for a period of two years from the date of purchase. If a product is found to have a defect in material or workmanship, we will take the appropriate actions defined in this warranty to resolve any issues.

The warranty program applies to any order, purchase, receipt, or use of any products sold by AC Infinity or our authorized dealerships. The program covers products that have become defective, malfunctioned, or expressively if the product becomes unusable. The warranty program goes into effect on the date of purchase. The program will expire two years from the date of purchase. If your product becomes defective during that period, AC Infinity will replace your product with a new one or issue you a full refund.

The warranty program does not cover abuse or misuse. This includes physical damage, submersion of the product in water, incorrect Installation such as wrong voltage input, and misuse for any reason other than intended purposes. AC Infinity is not responsible for consequential loss or incidental damages of any nature caused by the product. We will not warrant damage from normal wear such as scratches and dings.

Contact our dealers department at dealers@acinfinity.com or (626) 838-4656 for more information about our dealers and distributors program. Contact our customer service department at support@acinfinity.com or 626-923-6399 for product and warranty assistance. Our business hours are Monday through Friday, 9:00 am to 5:00 pm PST.



If you have any issues with this product, contact us and we'll happily resolve your problem or issue a full refund!

COPYRIGHT © 2023 AC INFINITY INC. ALL RIGHTS RESERVED

No part of the materials including graphics or logos available in this booklet may be copied, photocopied, reproduced, translated or reduced to any electronic medium or machine readable form, in whole or in part, without specific permission from AC Infinity Inc.

www.acinfinity.com